

FSB Ring Torsion Load Cell

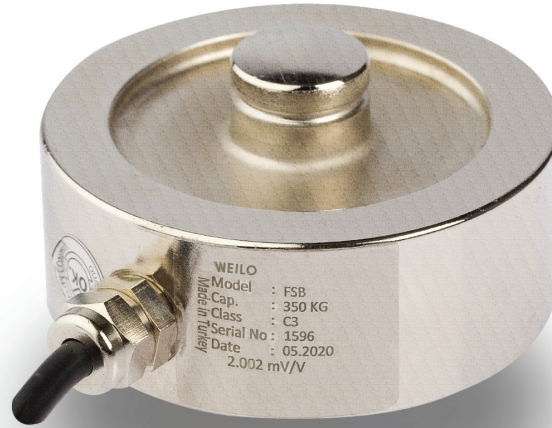

Bi-directional (compression-tension), high capacity and high precision industrial load cell.



ABOUT PRODUCT

FSB is a load cell with high accuracy and sensitivity that has a dual direction feature (compression-tension).

It is produced domestically at our Konya factory with capacity options ranging from 200 kg to 80 tons. After being treated with heat and alloyed steel, it is cleaned by sandblasting and completely homogenized before being coated with nickel for increased corrosion resistance, providing the ability for trouble-free use in the toughest conditions.

FSB compression type load cell allows easy use in all industrial applications with specially developed mounting kits.

APPLICATION AREAS



Agriculture and Livestock



Chemistry and Petrochemistry



Food



Textile



Machinery and Industry

CONNECTION DIAGRAM

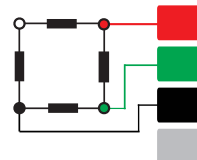

Red	Excitation+ (Input)
Green	Signal+ (Output)
Black	Excitation- (Input)
White	Signal- (Output)

WORK STYLE

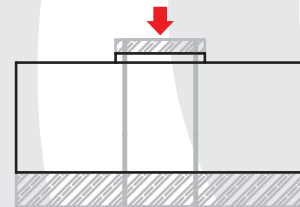

FEATURES

- ✓ IP 67 / IP 68 protection class
- ✓ Plated nickel, alloyed steel
- ✓ Ease of installation

TECHNICAL DRAWING

250 - 12500 Kg

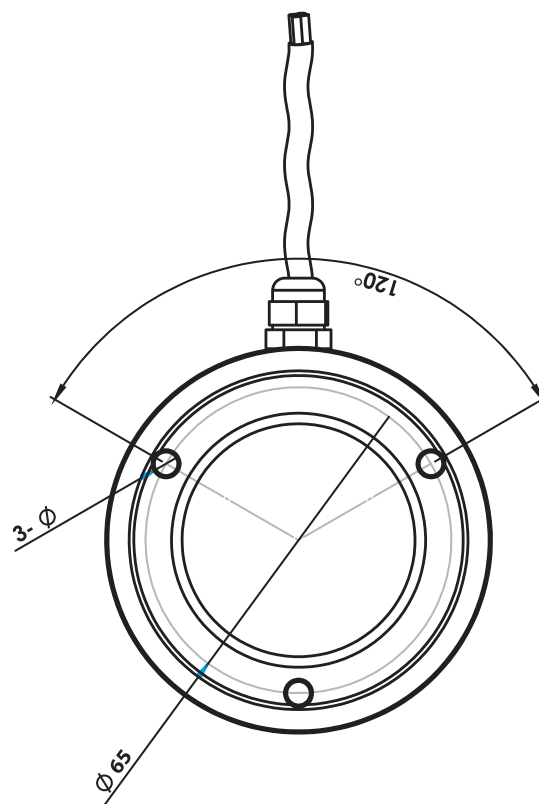
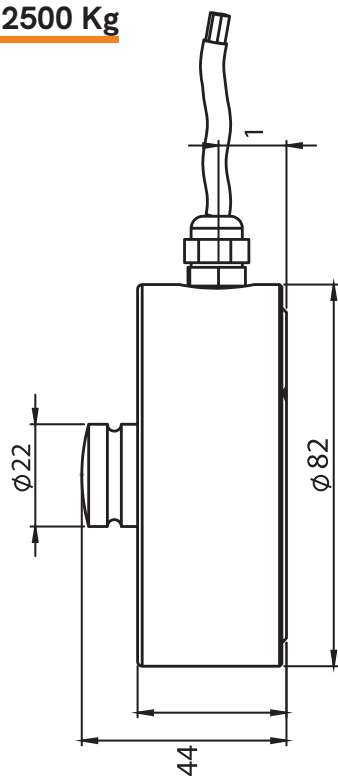

15 Tones

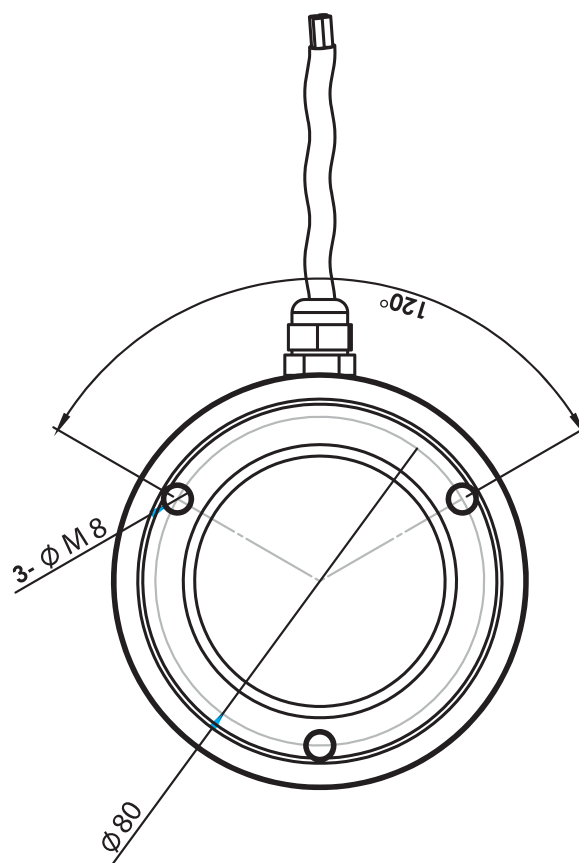
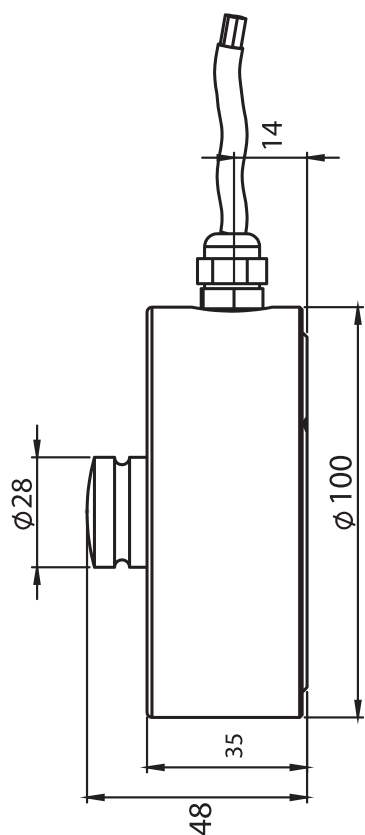

FSB Ring Torsion Load Cell

50 - 100 Tones

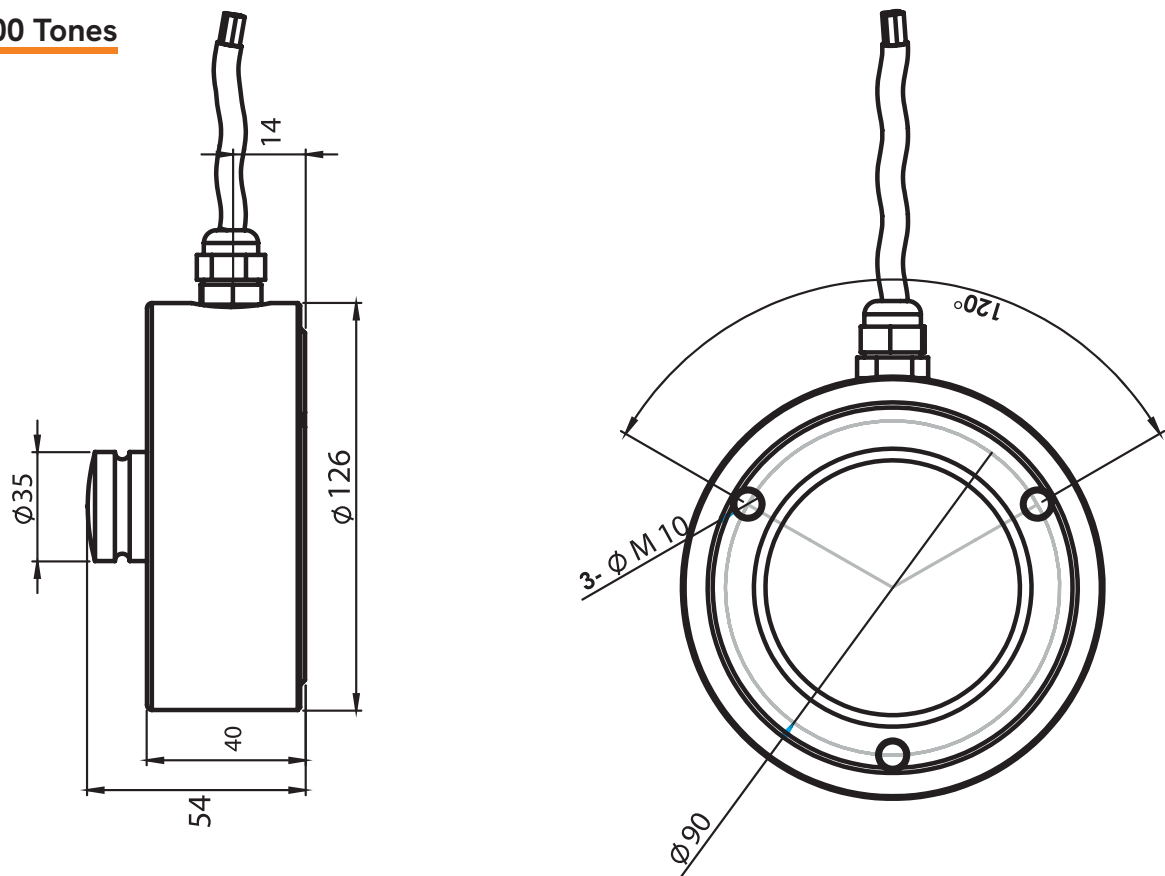

250 - 12500 Tones

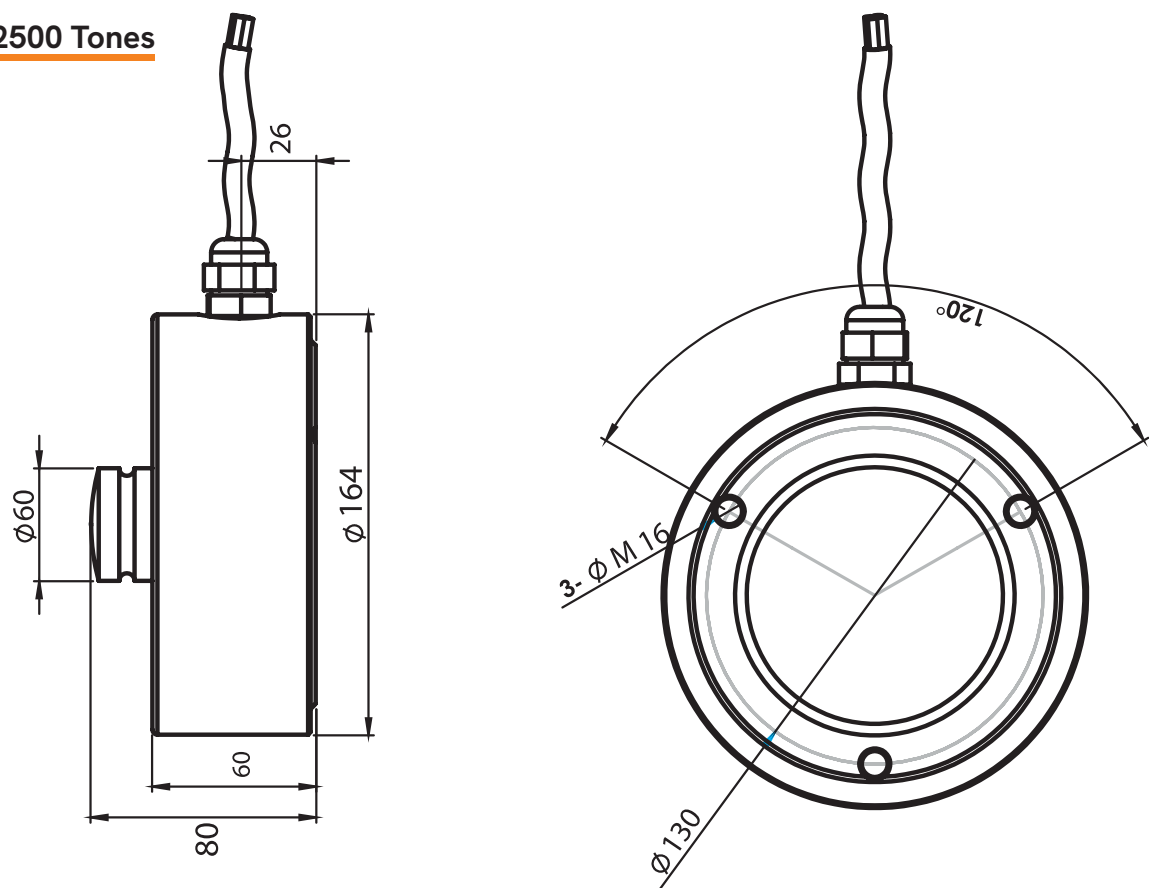

FSB Ring Torsion Load Cell

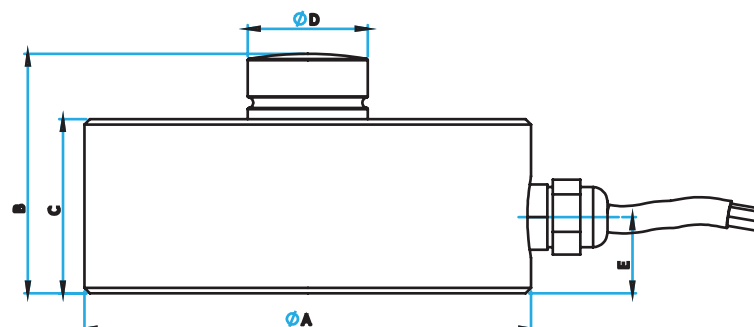

CAPACITY	A	B	C	D	E
250 - 12500 Kg	82	44	32	22	14
15 TON	100	48	35	28	14
30 TON	126	54	40	35	14
50 - 100 TON	164	80	60	60	26

TECHNICAL SPECIFICATION

Capacity	1 ~ 100 Tones
Accuracy Class	C1
Minimum Load	0 kg
Linearity	$\leq \pm 0.05 \%FS$
Repeability	$\leq \pm 0.05 \%FS$
Total Error	0.05 ~ 0.25
Output Sensitivity (FS)	2.00 mV \pm 0.005mV/V
Zero Balance	$\leq \pm 0.1 \%FS$
Input Resistance	750 Ω \pm 30 Ω
Output Resistance	703 Ω \pm 5 Ω
Isolation Resistance	$\leq 5000 M\Omega$ (100VDC)
Compensated Temperature	-10 ~ + 40 $^{\circ}C$
Operating Temperature	-30 ~ + 70 $^{\circ}C$
Excitation, Recommended Voltage	10 VDC
Maximum Excitation Voltage (Umax)	15 VDC
Safe Overload	150 % FS
Ultimate Overload	300 % FS
Ingress Protection (EN60529)	IP 67 / IP 68
Element Material	Alloyed Steel / Stainless Steel
Cable	4x0.22mm ²