

LFS-F Compression - Tension Load Cell



www.weilo.com.tr

Load cell with bidirectional operation (compression-tension) produced with high capacity and high precision.



ABOUT PRODUCT

LFS-F is a load cell with dual-directional operation (compression-tension) feature, produced with high capacity and high precision.

It is manufactured entirely in our Konya factory with capacity options ranging from 2 tons to 60 tons.

After being heat-treated and hardened with alloy steel, it is cleaned with sandblasting method and fully homogenized.

Then, it is coated with nickel for greater resistance against corrosion, providing a trouble-free use in the toughest conditions.

CONNECTION DIAGRAM

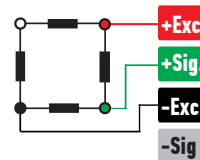

Red	Excitation+ (Input)
Green	Signal+ (Output)
Black	Excitation- (Input)
White	Signal- (Output)

WORK STYLE

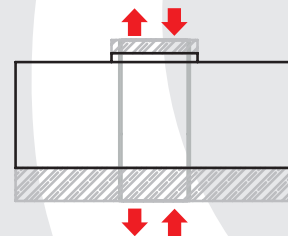

APPLICATION AREAS



Agriculture and Livestock



Logistics and Transport

FEATURES

- ✓ IP 68 protection class
- ✓ Plated nickel, alloyed steel
- ✓ Ease of installation

TECHNICAL DRAWING

2-3 Tones

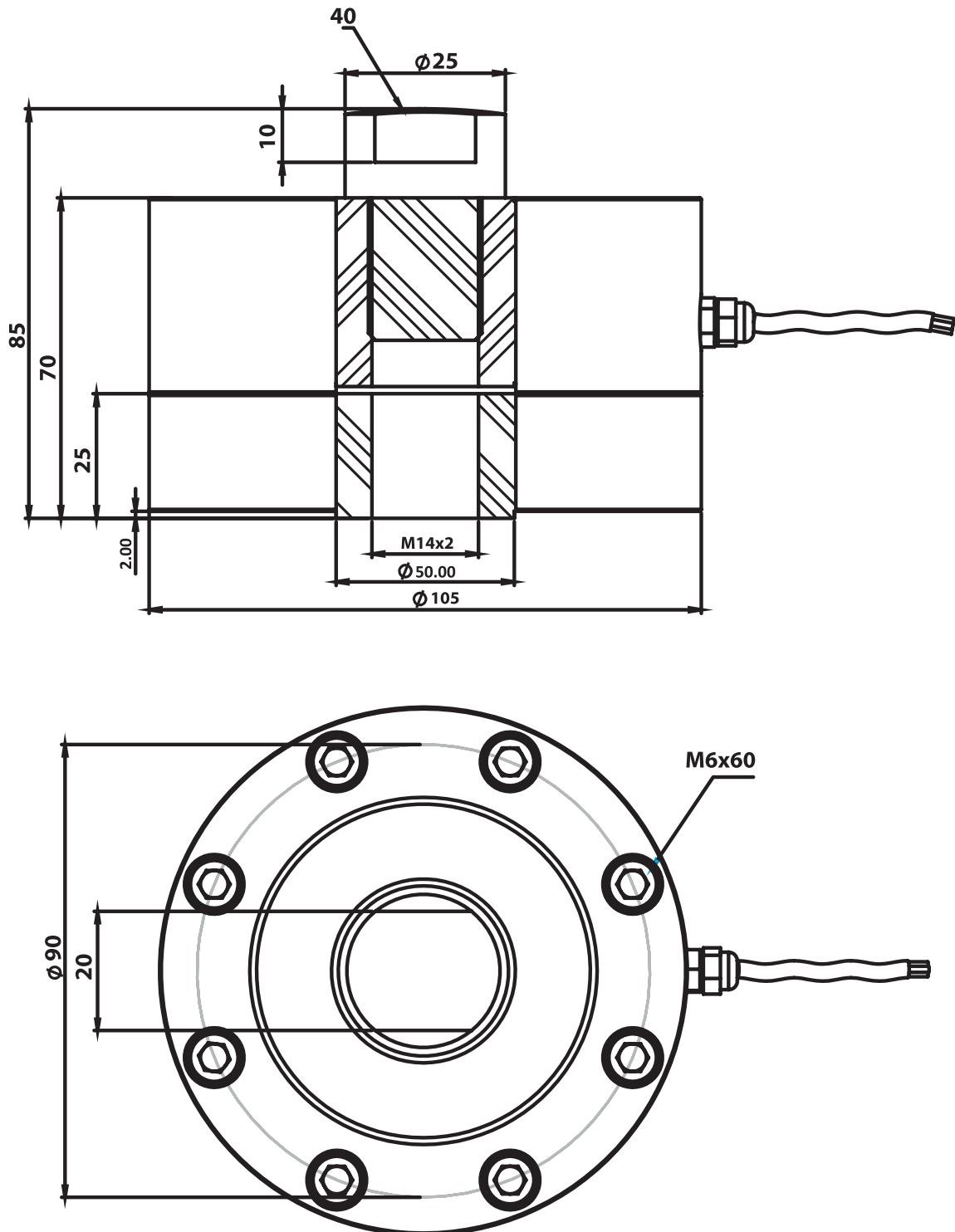

5 Tones

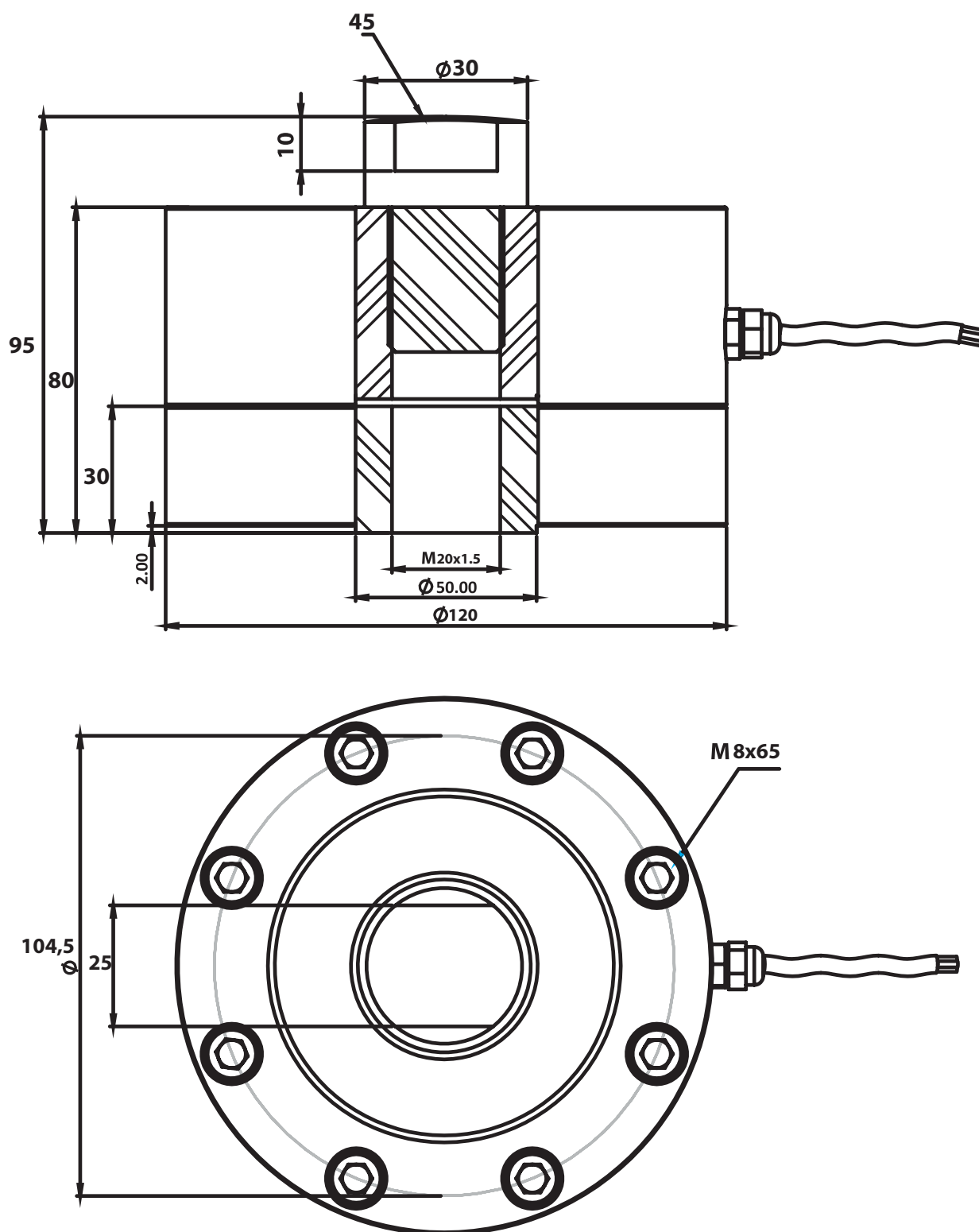

LFS-F Compression Tension Load Cell

10-20 Tones

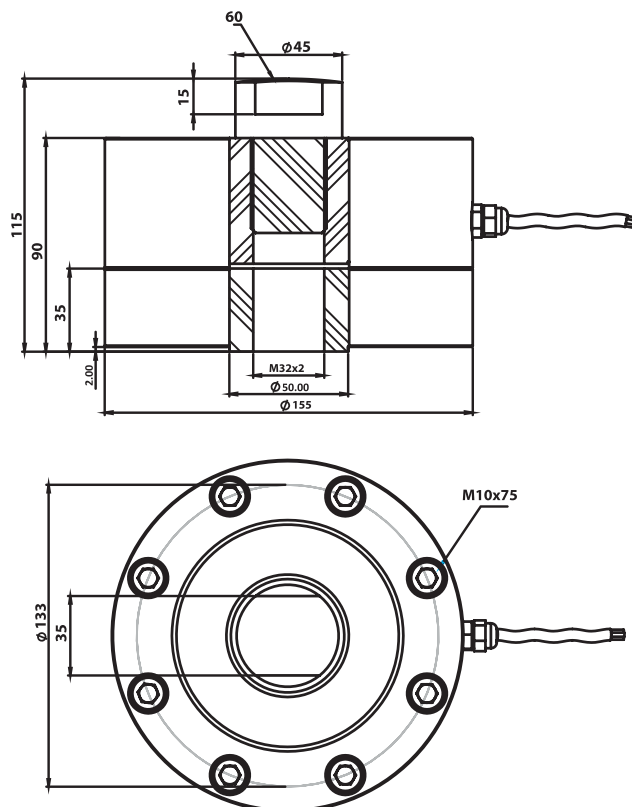

TECHNICAL SPECIFICATIONS

Capacity	2, 3, 5, 10, 20 Tones
Accu Class (ISO 376)	C1
Minimum Load	0 kg
Linearity	$\leq \pm 0.05 \%FS$
Repeability	$\leq \pm 0.05 \%FS$
Total Error	0.05 ~ 0.25
Output Sensitivity (FS)	2.00 mV/V $\pm 0.1 \% F.S.$
Zero Balance	$\leq \pm 0.1 \%FS$
Input Resistance	750 $\Omega \pm 30 \Omega$
Output Resistance	703 $\Omega \pm 5 \Omega$
Isolation Resistance	$\leq 5000 M\Omega$ (100VDC)
Compansated Temperature	-10 ~ + 40 °C
Operating Temperature	-30 ~ + 70 °C
Excitation, Recommended Voltage	10 VDC
Maximum Excitation Voltage (Umax)	15 VDC
Safe Overload	150 % FS
Ultimate Overload	300 % FS
Ingress Protection (EN60529)	IP 68
Element Material	Alloyed Steel / Stainless Steel
Cable	4x0.22mm ²